

ACCESSING REMOTE SOFTWARE SERVERS

Dominican University provides several, popular software packages to the community via the remoteapp.dom.edu and cists.dom.edu server. To access the software packages, follow the direction below:

From On-Campus using Windows:

1. Open a web browser and go to <https://remoteapp.dom.edu>
2. Enter the following data and then click *Sign in*:
 - In Domain\username, enter dom\ and then your username (ex: dom\tdkleine).
 - In password, enter your email password.

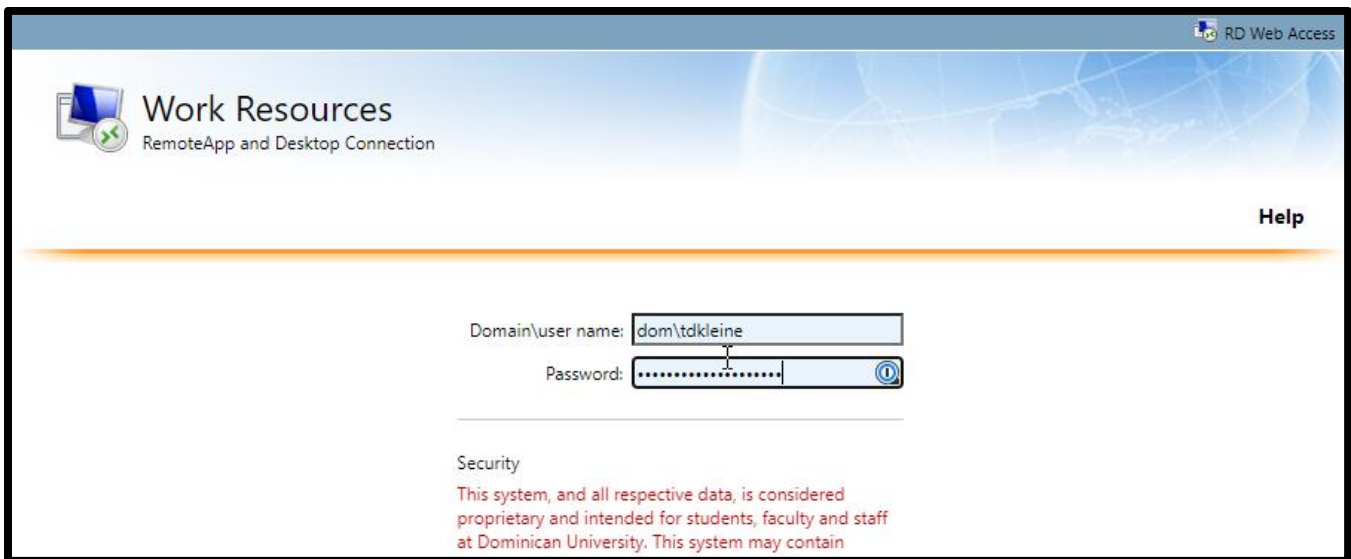

3. Click on the program you wish to use. After you click (1), a remote desktop file will download to your machine (2). Click on the file to launch the program:

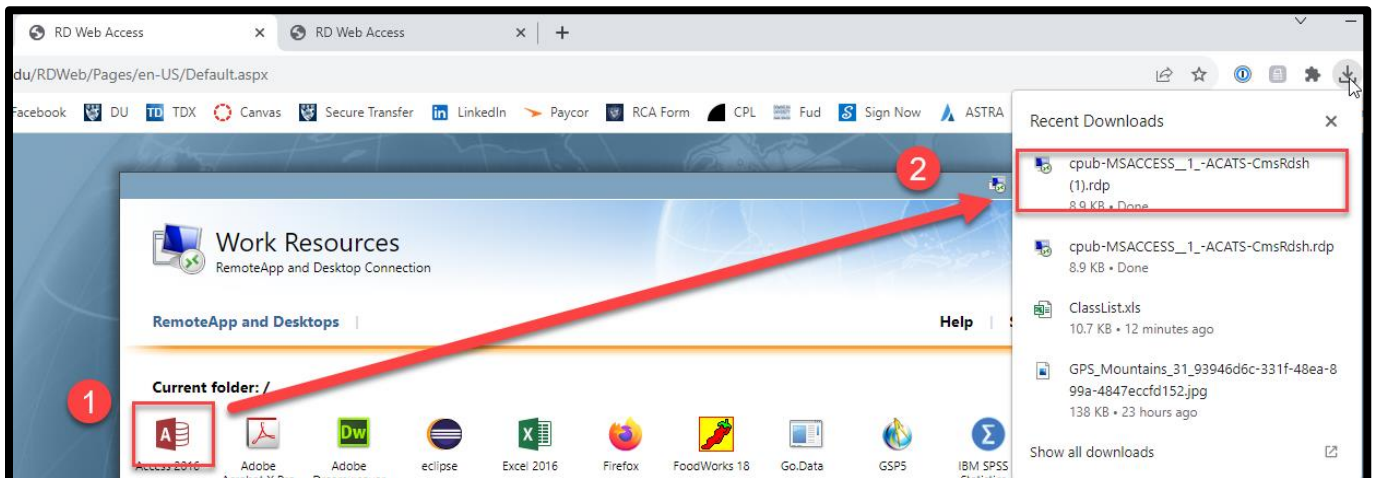

- Then, enter the following data and click sign in:
 - In username, enter dom\ and then your username (ex: dom\tdkleine).
 - In password, enter your email password:

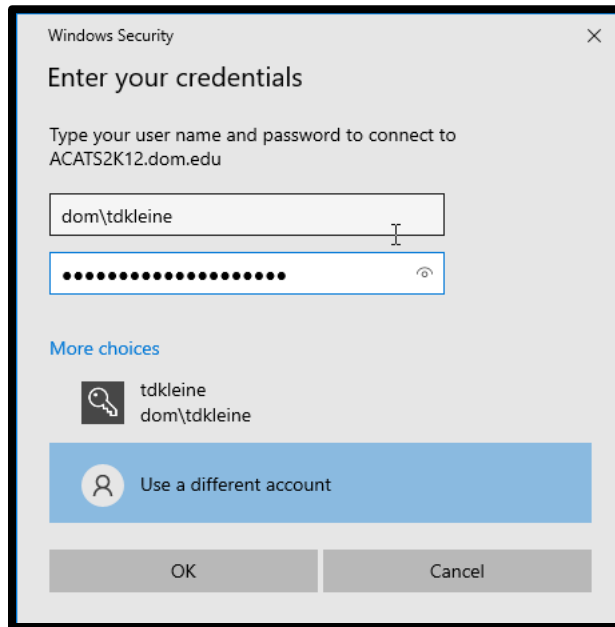

Please note: If you are using a Mac on campus, please visit [this link](#) for additional information.

From Off-Campus using Windows:

To access the software, you must first be enrolled in multi-/two-factor authentication (MFA) for your DU username and password. Enrollment is easy and must be completed by all students by October 15, 2023. For directions on how to enroll, [click on this link](#). Once you are enabled for MFA, you must download DU's VPN (Virtual Private Network) client, Global Protect. For directions on how to download and configure Global Protect, [click on this link](#).

Once you are enrolled in MFA and have the VPN/Global Protect software downloaded to your machine, follow these steps:

- Open a web browser and go to <https://remoteapp.dom.edu>
- Enter the following data and then click *Sign in*:
 - In Domain\user name, enter dom\ and then your username (ex: dom\tdkleine).
 - In password, enter your email password.

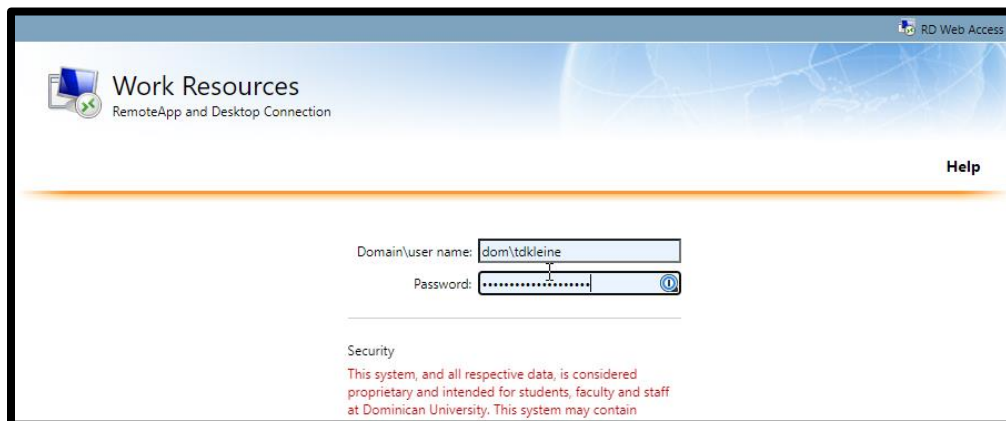

3. Click on the program you wish to use. After you click (1), a remote desktop file will download to your machine (2). Click on the file to launch the program:

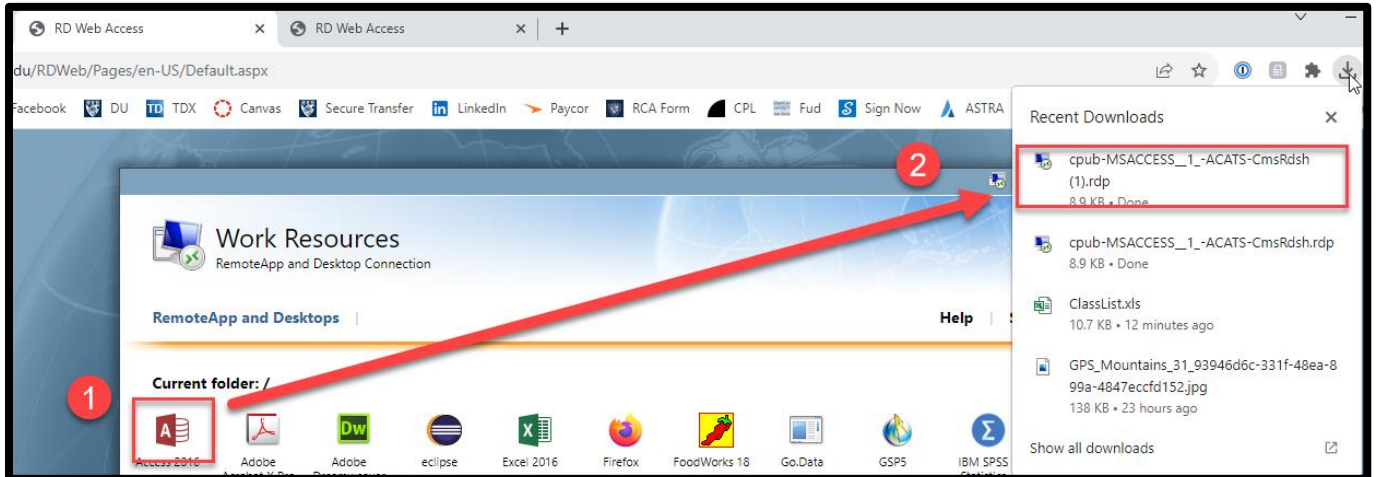

4. Then, enter the following data and click sign in:
- In username, enter dom\ and then your username (ex: dom\tdkleine).
 - In password, enter your email password:

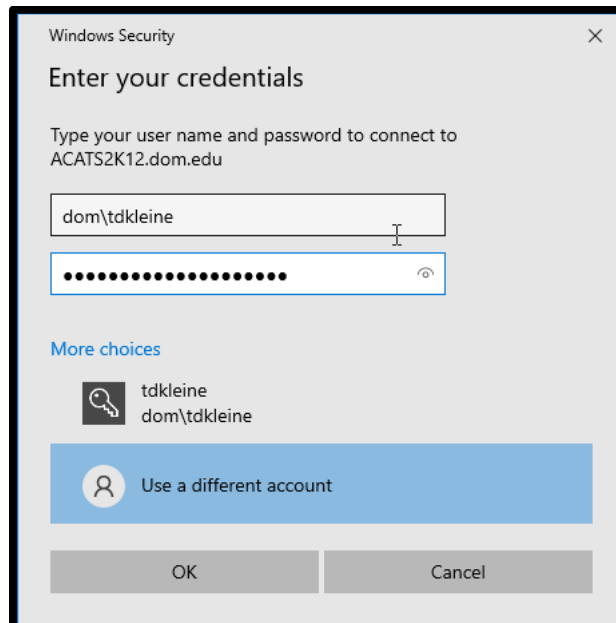

Please note: If you are using a Mac on campus, please visit [this link](#) for additional information.